

Quick Reference Instructions

These instructions are not a substitute for the operator's manual. Please be sure to read the operator's manual thoroughly prior to operating the pump. * See other side for pump operating instructions.

Priming and Loading the Disposable Set



STEP 1

Remove cap on Infinity Orange 100 ml disposable set. Hold bag upright and pour in feeding solution. Close cap securely. *NOTE: If you are using the EnteraLite Infinity 500 ml or 1200 ml disposable set, follow the same instructions.*

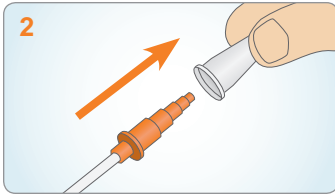

STEP 2

Remove protective cover from barbed adapter.



STEP 3

Turn bag upside down and gently squeeze. Tilt bag as needed to keep air at tubing port. At the same time, gently pinch orange colored tubing **below** the "D" symbol. Hold this position until air is removed from tubing. Gently squeeze bag at same time to assist fluid flow.

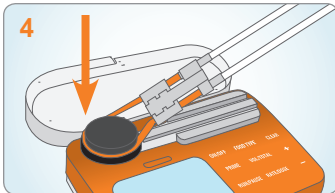

STEP 4

Loop silicone tubing around pump wheel stretching lightly. Seat cassette into pump. Close pump door.



STEP 5

Press and hold ON/OFF key for 1.5 seconds to turn pump on. If any air remains in tubing, press and hold the PRIME key until formula reaches the red barbed adapter.

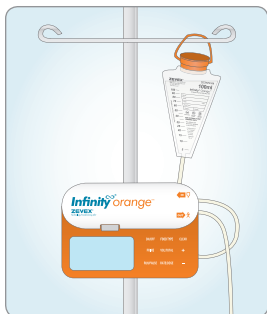

Programming & Running the Pump

Before attempting to program the pump, be sure to prepare the disposable set with enteral feeding solution. * See other side for delivery set priming and loading instructions.

STEP 1

Hang delivery set so that the bottom of the bag is at or above the level of the pump door.

- OR -

Fit pump and set into a ZEVEX carry pack, securing pump, bag, and tubing with the pack's straps.



STEP 2

Press and hold **ON/OFF** key for 1.5 seconds to turn pump on. After running the self test, display will show last programmed rate.



STEP 3

Program the prescribed rate using the + and - keys.



STEP 4

Press **RATE/DOSE** key to display dose. Program the prescribed dose using the + and - keys.



STEP 5

Press the **FOOD TYPE** key to display type of food to be delivered. Press the + and - keys to change between formula and human milk.

STEP 6

Connect barbed adapter to patient's feeding tube.



STEP 7

Press **RUN/PAUSE** key to start the pump.



STEP 8

When feeding is complete, press **ON/OFF** key for 1.5 seconds to turn the pump off.

NOTE: User must confirm each parameter (rate, dose, and food type) before pump will start. If dose and food type are not viewed prior to pressing the RUN/PAUSE key, pump will alarm and display CON FIRM DOSE AND FOOD TYPE.

NOTE: Rate, dose, and food type settings can be locked so that changes cannot be made. See the User Preference Settings section of the Infinity Orange Operator's Manual for additional information.

ZEVEX®
Enteral Nutrition Delivery Systems

4314 ZEVEX Park Lane
Salt Lake City, Utah 84123 USA
toll free: (800) 970-2337
tel: (801) 264-1001
fax: (801) 264-1051
www.zevex.com